

# LED WALL WASHER



## Instructions for LW36-RGB 120V, 60Hz AC Operation

**WARNING:** These products may represent a possible shock or fire hazard if improperly installed or attached in any way. Products should be installed in accordance with these instructions, current electrical codes, and/or the current National Electric Code (NEC).

**WARNING:** To avoid electrical shock, disconnect or disable power at the source prior to installation or maintenance!

### IMPORTANT SAFETY INSTRUCTIONS - Do not begin installation until you read and understand the installation and safety instructions.

1. All units must be unplugged before installing or servicing in any way.
2. Do not route cords or units through walls, doors, windows, or any similar part of a building structure.
3. When using outdoors, controller (if applicable) must be secured in a weatherproof enclosure.
4. Do not use if there is any damage to the unit, its lens, and/or power cord's insulation. Inspect periodically.
5. Suitable for wet locations (IP65). Do not locate fixture where it will stand in water or where water will accumulate.
6. Secure units using mounting hardware appropriate for the mounting surface. Do not secure unit or its power cord with staples, nails, or like materials that may damage insulation.
7. Do not attempt to open or service this fixture. None of its parts are serviceable by the user.
8. Do not exceed the specified voltage and current input.
9. If using in conjunction with the LW36-CON controller, do not exceed the maximum run of thirty units.
10. This product has a polarized, grounded plug as a safety feature to reduce the risk of electric shock. Do not cut the plug off or alter it in any way.

### READ ALL INSTRUCTIONS

**WARNING:** When using outdoor use portable luminaires, basic safety precautions should always be followed to reduce the risk of fire, electric shock, and personal injury, including the following:

- a) Use only three-wire outdoor extension cords that have three-prong grounding plugs and grounding receptacles that accept the appliance's plug.
- b) Ground Fault Circuit Interrupter (GFCI) protection is to be provided on the circuit(s) or outlet(s) to be used for the wet location portable luminaire. Receptacles are available having built-in GFCI protection and are able to be used for this measure of safety.
- c) Use only with an extension cord for outdoor use, such as an extension cord of cord type SEW, SEOW, SEOOW, SOW, SOOW, STW, STOW, STOOW, SJEW, SJEOW, SJEOWW, SJW, SJOW, SJOOW, SJTW, SJTOW, or SJTOOW.

### SAVE THESE INSTRUCTIONS

#### INSTALLATION PLANNING:

##### Plan ahead for quick, successful installation.

1. Review all wiring plans in advance. Refer to local and state codes for installation compliance.
2. Make a fixture layout plan that shows locations of each fixture and the controller. Leave room or create a legend to record the fixture "IDs" (identifying number for fixture addressing purposes).
3. As you unpack each fixture, attach a weatherproof label on the fixture to reference its location in the lighting installation plan. This will help speed the installation and identify units for addressing purposes. See Figure 1.

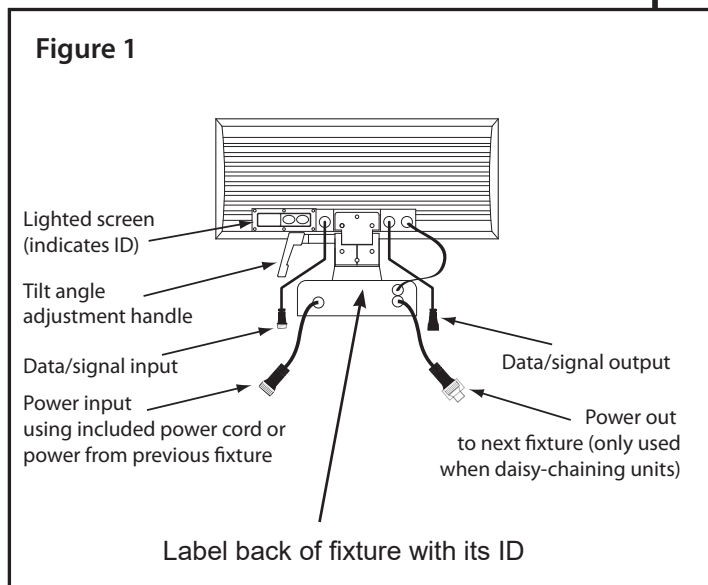

# LED WALL WASHER



## Instructions for LW36-RGB 120V, 60Hz AC Operation

### INSTALLATION CONSIDERATIONS:

The maximum number of fixtures that can be controlled by the LW36-CON controller is thirty (30). For any project that requires more than thirty fixtures, please consult factory.

1. Calculate the number of fixtures to be used. Consider the locations of all fixtures and of the controller.
2. Create a lighting plan that uses either a series configuration (where each unit is powered by the previous one) or provide a receptacle for each unit. See Figure 3 and 'Fixture Installation'. Locate the controller within 175 feet of the last fixture in a series. Note: The controller is usually installed after the fixtures are in place and will require its own 120V AC outlet within 7 feet of its location.
3. Be sure to provide a 120V AC, grounded outlet within 5 feet of the first fixture's location. If outdoors, outlet(s) must also be GFCI and weatherproof. If linking power, purchase 15' linking power cables (indoor use, up to five fixtures only) as necessary or locate an outlet for each.
4. Consider what mounting hardware will be used. The mounting surface will dictate the type of fastener. The base has through-holes for mounting.

### FIXTURE INSTALLATION:

1. Be sure to record the fixtures' IDs on the lighting plan. Label the fixtures with their assigned locations by attaching a weatherproof label to each unit.
2. Set the fixtures' IDs. Note: If you want all of the fixtures to be synchronized, give them all the same ID\*. To change the fixture's ID, simply press the contact buttons on the back next to the LED screen (one will advance IDs, the other will lower ID numbers). The fixture's ID will be held in memory even when unplugged or otherwise powered off.
3. Rotate and hold the light in the desired position with the LED array facing the surface to be lighted. Note: the LED Wall Washer doesn't have a rotational adjustment, only a tilt adjustment. See Figure 2.
4. Use the through-mounting holes in the base of each unit and suitable fasteners to mount the Wall Washer to the mounting surface.
5. Attach the cord and plug set to the fixture and plug in or power the fixture directly from a previous fixture using the 15' power cable (part number LW36-EX15, indoor use only, sold separately). See Figure 3.
6. Loosen the handle that holds the tilt angle for the array and tilt fixture to desired angle. Re-tighten this handle to hold the tilt angle.

### CONTROLLER INSTALLATION:

Note: Each fixture is factory-set to ID = 001 as indicated on the lighted screen on the back of the array. See Figure 1. If the ID is left as 001, the unit will begin to advance through a factory-set color sequence. A controller is required to produce synchronous color changing mixes and for use as a DMX interface. For advanced lighting "scenes", use DMX software\*, such as DMX-PLAY, using LW36-XLR3 (XLR3 adapter cable); each sold separately.

1. Determine the location of the controller and plug in the controller. (If your installation uses more than one controller, please consult factory.) Refer to controller instructions for user programming instructions.
2. Connect the controller's data output cable (mini 3-pin female) directly to the data input cable of the fixture (mini 3-pin male) or interconnect using 15' signal cable, (part number LW36-EC15, sold separately), if needed. See Figure 3.
3. Daisy-chain the remaining fixtures directly or with 15' signal cables, as needed.

\*Specialized DMX software will allow multiple IDs for advanced effect lighting. All fixtures connected to the LW36-CON controller will automatically synchronize. When using DMX 512 software, refer to that company's instructions.

Figure 2

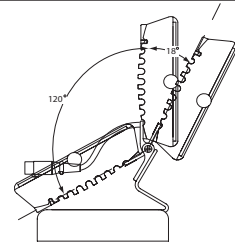

The LED Wall Washer has an adjustable tilt but the base doesn't rotate.

Figure 3

