

120V Puck Light

Installation Instructions for LVPX, ALLVP and LVPH Series



WARNING: These products may represent a possible shock or fire hazard if improperly installed or attached in any way. Products should be installed in accordance with these instructions, and with current electrical codes and/or the current National Electric Code (NEC).

Warning: To avoid electric shock, disconnect power prior to installation.

Caution: Injury to persons and damage to the fixture and/or mounting surface may result if the fixture is pulled from the surface. To reduce the likelihood of such injury or damage, mount on a surface that is mechanically sound.

SURFACE MOUNTING:

1. Locate desired position for the cabinet light.
2. Remove the lens cover from housing by rotating counter-clockwise.
3. Route the wire through surface ring notch, or if desired drill a hole through the mounting surface and route wires through hole. Be sure to position the surface ring so the notch faces the rear of the cabinet.
4. Make sure there is no contact between the hot lamp, lampholder, or reflector, and any combustible material such as plastic or paper goods, or the wire insulation.
5. Mount surface ring and housing assembly with the three wood screws provided.
6. Replace lens cover by rotating clockwise.
7. Route unit's wire to ALSLBOX. CAUTION: Do not route wires and extension cords through walls. Use for external cabinet applications only.
8. Not intended for permanent hardwire installation inside built-in furnishings such as kitchen cabinets or trophy cases without the use of the direct wire box ALSLBOX (sold separately).
9. Do not conceal power supply cord, linking extensions or direct wire box inside walls, ceilings, or floors.
10. Multiple pucks can be linked together with 12" and 24" extensions.
11. Make sure last puck in the set is the one without a tail wire.

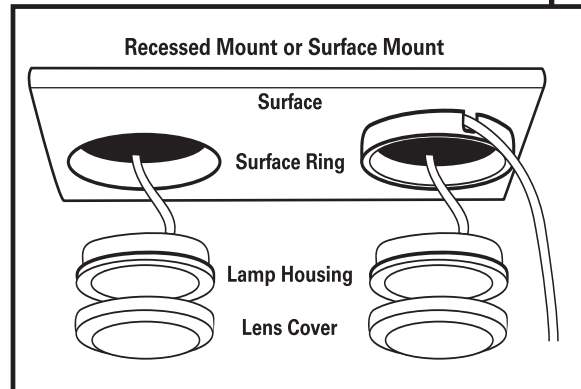

RECESSED MOUNTING: CAUTION! Risk of fire! Install as recessed only where top of cabinet is not enclosed.

1. Drill a 2-1/8" hole in the desired location.
2. Remove the lens cover from housing by rotating counter-clockwise.
3. Do not use surface can for recessed applications.
4. Feed wires through hole and push light housing into hole. Make sure there is no contact between the hot lamp, lampholder, or reflector, and the wire or any combustible material such as plastic or paper goods. Secure the light supply leads to avoid the likelihood of the leads contacting the cabinet light. Use the three wood screws to fasten the housing in place.
5. Follow steps 6-11 above.

IMPORTANT SAFETY INSTRUCTIONS: PLEASE SAVE!

WARNING! To reduce the risk of fire, electric shock, exposure to excessive UV radiation, or injury to persons: **LIGHTED LAMP IS HOT!**

TO REPLACE BULB:

1. Unplug unit or turn roll switch to "off" position and allow lamp to cool before replacing bulb.
2. Use only 120 volt, 20 watt maximum Xenon bulb (LVPX20BP) or Halogen bulb (ALLVP20B).
3. Twist lens cover counter-clockwise to remove.
4. Insert bulb, using a soft cloth. Do not touch bulb with fingers.
5. Replace lens with a slight clockwise motion.

ADDITIONAL SAFETY MEASURES:

1. Bulb gets hot quickly. Contact only switch/plug when turning on.
2. Do not touch hot lens, lens holder or enclosure.
3. Do not remain in light if skin feels warm.
4. Do not look directly at lighted bulb.
5. Keep lamp away from curtains, draperies and similiar materials that may burn.
6. Do not operate lamp with a missing or damaged lens.



AMERICAN LIGHTING
BRIGHT IDEAS • INNOVATIVE PRODUCTS

120V Puck Light Installation Instructions for LVPX, ALLVP and LVPH Series



TO ADJUST CORD LENGTH FOR KITS:

1. If wire plug cover is still attached to plug, slide cover off by pushing away from plug. (See Figure 1)
2. Insert trimmed end of cord into plug pocket, nearest the polarized blade (wide blade).
Be sure that the ribbed side of cord goes over the right piercing point, and smooth side of cord goes over the left piercing point. (See Figure 2)
3. Slide plug cover back onto wire plug (Figure 3), and route plug to nearest convenience outlet.
4. Multiple pucks can be linked together with 12" and 24" extensions.

IMPORTANT SAFETY INSTRUCTIONS: PLEASE SAVE!

This fixture has a polarized plug (one blade is wider than the other) as a safety feature to reduce the risk of electric shock. This plug will fit in a polarized outlet only one way. If the plug does not fit fully in the outlet, reverse the plug. If it still does not fit, contact a qualified electrician. Never Use with an extension cord unless the plug can be fully inserted.

Do not alter the plug.

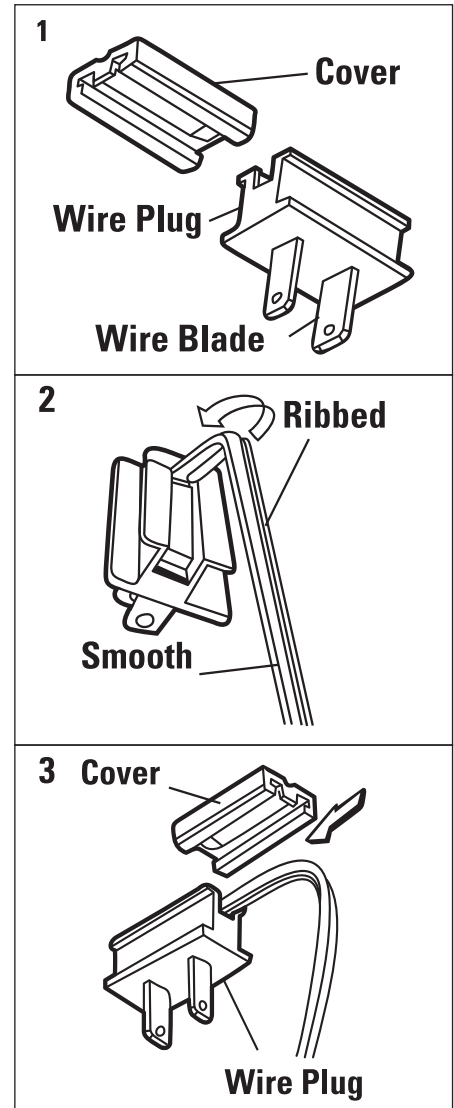

AMERICAN LIGHTING
BRIGHT IDEAS • INNOVATIVE PRODUCTS

RV1439